

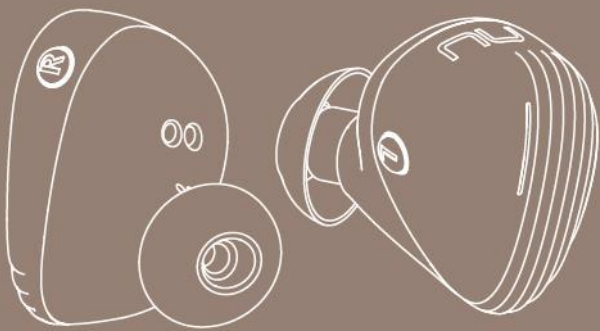

NU FORCE

BE Free8

Truly Wireless Premium Earphones



User Manual

User Manual

Optoma NuForce BE Free8

Truly Wireless Premium Earphones





Regulatory model name: APBEFREEB

Version VA3.5

Contents

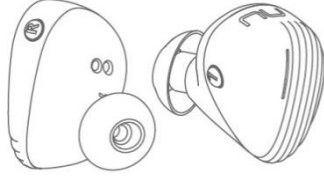
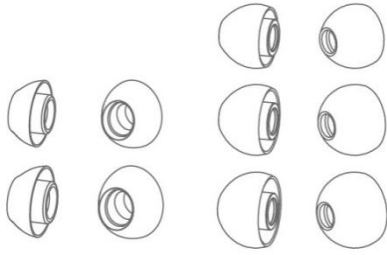
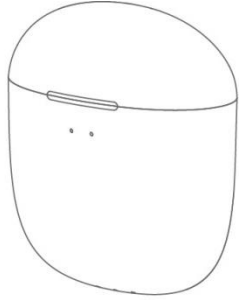
- **WHAT'S IN THE BOX**
- **BE Free8 EARPHONES**
- **THE BASICS**
 - Charging your BE Free8**
 - Battery Low Alarm and Battery Status**
 - Bluetooth pairing**
 - Power On/ Power Off**
 - Wearing your BE Free8**
 - Handling phone calls and Siri/Google voice**
 - Listening to music**
- **MISCELLANEOUS**
 - Restoring factory settings**
 - Voice prompts list**
 - Disclaimer**
 - FCC Interference statement**
 - CE**
 - Trademark attribution**
 - Specification**

WHAT'S IN THE BOX

<p>BE Free8 earphones</p>	
<p>Silicon tips 2 types of silicon tips Total of 5 pairs ear tips</p>	
<p>Charging case</p>	
<p>Charging cable (Micro-USB)</p>	
<p>Basic user's manual</p>	
<p>Safety Instruction</p>	

BE Free8 EARPONES

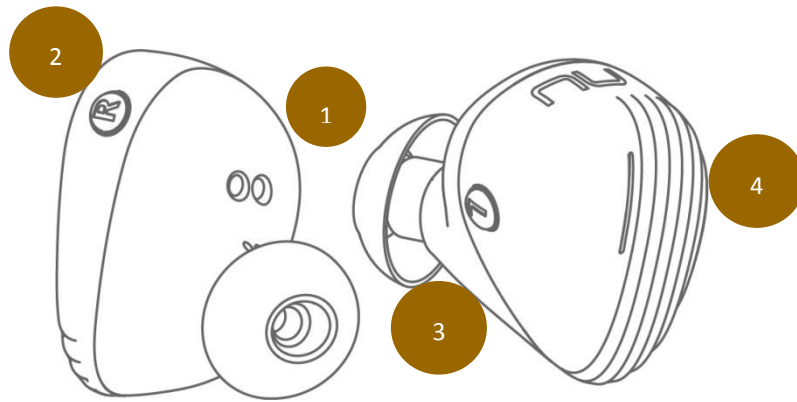

1. Charge jack
2. Multifunction button
3. Microphone
4. LED indicator

The BASICS

Charging Your BE Free8

Although your BE Free8 earphones come with a partially charged battery, it is recommended that you fully charge your BE Free8 before first use.

1. Put your BE Free8 into the charging case.
The charge cable should be connected to the charge port of charging case and either to a PC or a dedicated USB charger.
2. When charging, the LED indicator(s) on the charging case will flash every 5s.
3. Once charging is complete, LED Indicator turns on continuously for 10 seconds and then turn off.

NOTE:

- A. It takes up to 2 hours to fully charge the left and right earpiece.
- B. When charging, the LED indicator on the earpiece will flash orange.
- C. To maintain the best performance of the battery, we recommend that the battery in both the earpieces and charging case are charged regularly. Do not deplete the battery of the earpieces and charging case before charging.

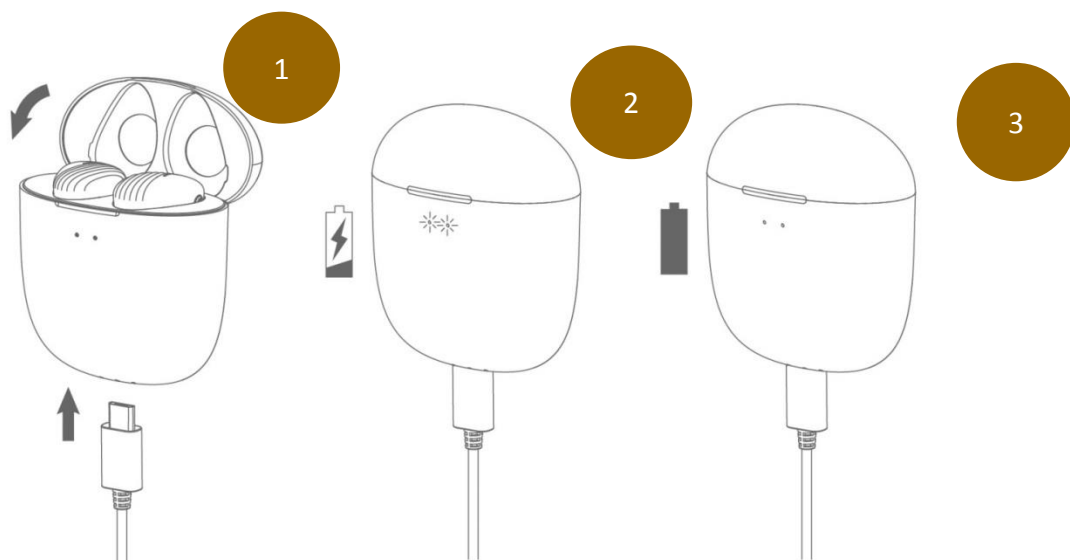

Please note, low battery of the charging case might cause abnormal functionality such as auto on and auto off.

Battery Low Alarm and Battery Status

When the battery level is very low, you will hear a “Battery Low” voice prompt from your BE Free8 every 2 minutes when the estimated battery reserve remaining time is under 15 minutes.

Users with iOS devices and some Android models will be able to view the battery status on their device’s display

Bluetooth Pairing

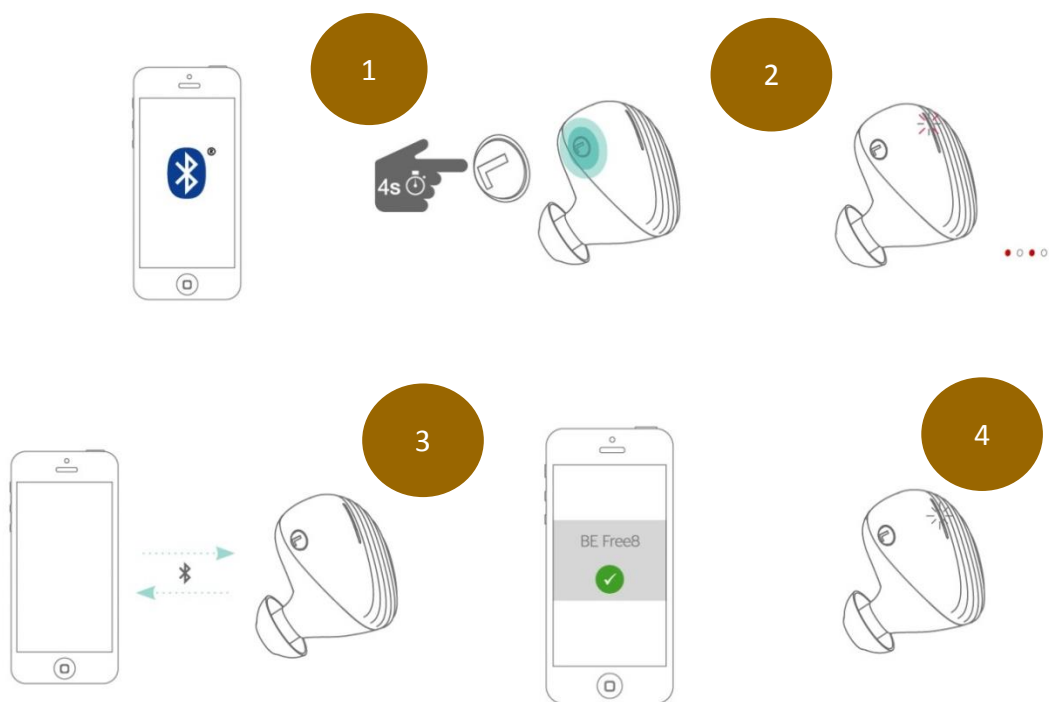

Using your BE Free8 for the first time

Pairing BE Free8 Left earpiece with source device

1. When pick up left earpiece from the charging case, press and hold the BE Free8's Power/Function button for 4 seconds until the LED indicator light flashes orange and white. Your BE Free8 is now in pairing mode.
2. Turn on *Bluetooth*® on your source device, then select "BE Free8" once it appears on the device list.
3. Once successfully paired, the LED indicator will flash white and you hear "Primary device connected" from your BE Free8.

NOTE: Consult your source device's user manual for instructions on activating Bluetooth.

Pairing BE Free8 Right earpiece with Left earpiece

1. Turns on the right earpiece and plug both (right and left) earpieces in ear, both earpieces will automatically connected.

NOTE:

- A. *You must always enter "Pair" mode from a powered-off state. Otherwise, pushing the Power/Function button for more than 4 seconds from a powered-on state turns the BE Free8 off.*
- B. *If left inactive in pairing mode, your BE Free8 will automatically power off after 5 minutes.*
- C. *Your BE Free8 can store pairing information for up to eight devices.*

To pair additional devices to your BE Free8 ensure that your BE Free8 is not concurrently connected to any device, then repeat the steps 1,2,3 outlined above.

In case your BE Free8 have already stored pairing information for eight devices and a ninth device is paired, the stored information for the very first device will be deleted.

Power On/Power Off

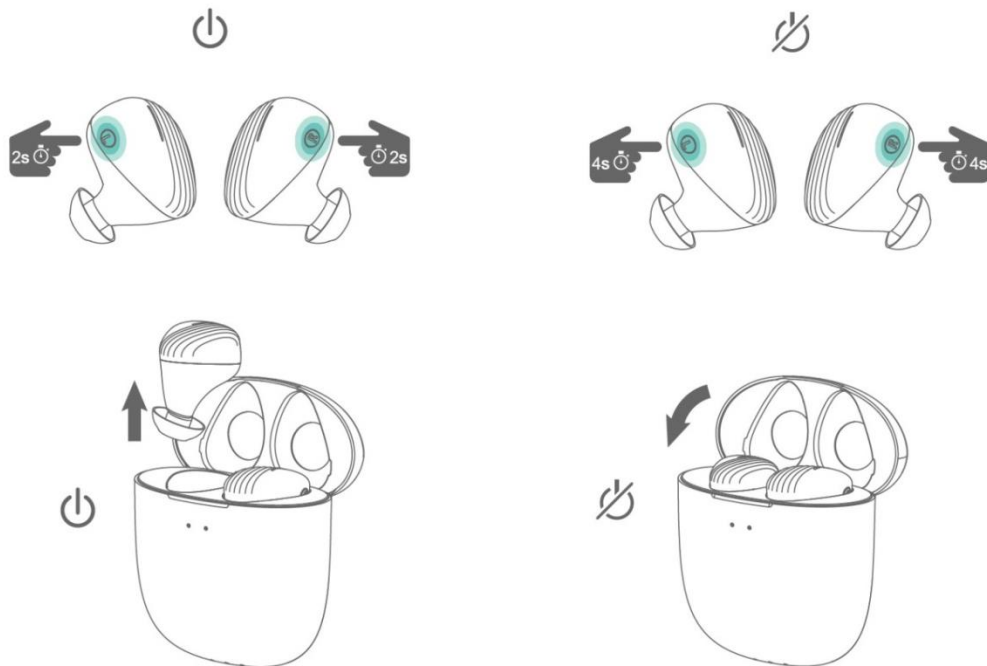

There are two ways to turn on your BE Free8

- 1) When charging case is activated *, pick up the Left earpiece from the charging case, it will automatically power on. Then pick up right earpiece and press MFB for 2 seconds to turn it on.
- 2) When your BE Free8 is not in the charging case and is in OFF state, press Power/Function button for about 2 seconds until the LED indicator flashes white and you hear the “Power on” on the left earpiece.

NOTE:

Once you have successfully paired the BE Free8 to a Bluetooth-enabled device, the BE Free8 will automatically connect with that device once it is powered on again. For more information check “Bluetooth Pairing” section.

* The BE Free8 charging case is designed with a power saving mode. The power saving mode will be activated after 12 hours of not using the charging case. Once activated the left earpiece “auto on” feature will be disabled. To activate the charging case, open the top cover of charging case.

To turn the BE Free8 to OFF, either place each earpieces back into the charging case, or to push Power/Function button for about 4 seconds until the LED indicator turns orange and you hear the “Power off”.

Wearing Your BE Free8

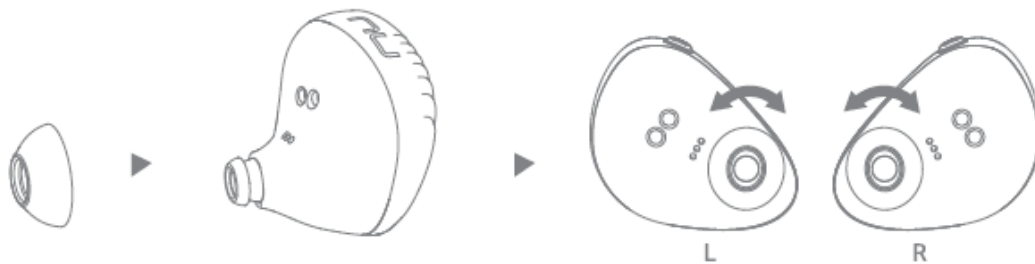

To ensure a secure and comfortable fit when wearing your BE Free8:

1. Select right size of ear tips and install tips on BE Free8.*
2. Rotate the SpinFit tips CP350 (if wearing this type) and place the BE Free8 into each ear so that they are positioned comfortably.

NOTE: *5 pairs of silicone (SpinFit CP350 and CP100/Z) tips are provided to offer optimal user's comfort.

Handling Phone Calls and Siri/Google voice

When your BE Free8 are connected to a *Bluetooth*-enabled smartphone, you can handle your phone calls directly using MFB on left earpiece.

The followings describe phone call options:

Call option	Status	Action
Answer a call	Incoming call	Tap the Power/Function button on left earpiece
End a call	In a call/outgoing call	Tap the Power/Function button on left earpiece
Activate Siri (iOS) or Google Voice Search (Android)	Standby/Connected	Press the Power/Function button on left earpiece for 2 seconds. To stop it, by clicking on Power/function button

To activate Siri and Google voice from listening music or in idle:

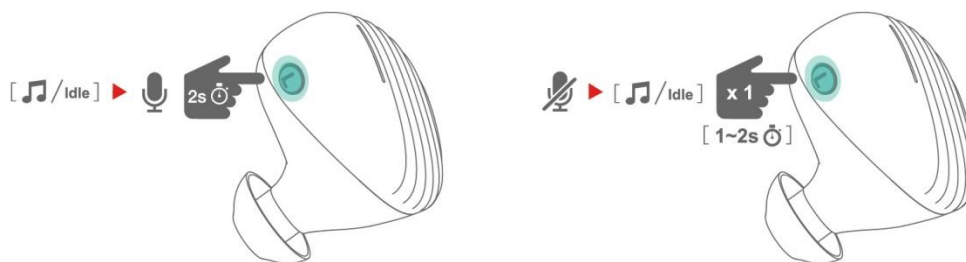

Listening to Music

You can enjoy and control audio through the in line controller on your BE Free8.

Audio option	Action
Play or pause audio	Tap the Power/Function button on left earpiece
Skip to next track	Double click on the Volume Up button of left earpiece

MISCELLANEOUS

Restore Factory Settings

When you restore the BE Free8 to its factory settings, the paired devices stored will be deleted.

To restore factory settings:

- 1** Ensure that your BE Free8 are not connected to any device.
- 2** Put the BE Free8 in pairing mode.
- 3** Double click on the Power/Function button on the left earpiece until the LED indicator flashes white six times following orange/white flashes alternately, and you hear short tones from the BE Free8.

Because all pairing information is deleted after restoring factory settings, the BE Free8 will directly enter pairing mode once powered on.

Voice Prompts list

The BE Free8 are pre-loaded with English voice prompts

“Power On”

“Power Off”

“Battery Low”

“Primary device connected”

“Pairing Mode Activated”

“Device disconnected”

Disclaimer

Please be advised, the BE Free8 is equipped with the latest technology however functionality may vary by device.

Federal Communication Commission Interference

Statement

This equipment has been tested and found to comply with the limits for a Class B digital device, pursuant to two different Part 15 rules sections of the FCC. These limits are designed to provide reasonable protection against harmful interference in a residential installation.

This equipment generates, uses and can radiate radio frequency energy and, if not installed and used in accordance with the instructions, may cause harmful interference to radio communications. However, there is no guarantee that interference will not occur in a particular installation. If this equipment does cause harmful interference to radio or television reception, which can be determined by turning the equipment off and on, the user is encouraged to try to correct the interference by one of the following measures:

- . Reorient or relocate the receiving antenna.
- . Increase the separation between the equipment and receiver.
- . Connect the equipment into an outlet on a circuit different from that to which the receiver is connected.
- . Consult the dealer or an experienced radio/TV technician for help.

FCC Caution: To assure continued compliance, any changes or modifications not expressly approved by the party responsible for compliance could void the user's authority to operate this equipment. (Example - use only shielded interface cables when connecting to computer or peripheral devices).

FCC Radiation Exposure Statement

This equipment complies with FCC RF radiation exposure limits set forth for an uncontrolled environment. This equipment should be installed and operated with a minimum distance of 0.5 centimeters (.20 of an Inch) between the radiator and your body.

This transmitter must not be co-located or operating in conjunction with any other antenna or transmitter.

The antennas used for this transmitter must be installed to provide a separation distance of at least 0.5 centimeters (.20 of an Inch) from all persons and must not be co-located or operating in conjunction with any other antenna or transmitter.

This device complies with two different Part 15 rules sections of the FCC. Operation is subject to the following two conditions:

- (1) This device may not cause harmful interference, and
- (2) This device must accept any interference received, including interference that may cause undesired operation.

CE

EU Regulatory Conformance Hereby, Optoma Corporation declares that this device is in compliance with the essential requirements and other relevant provisions of Directive 2014/53/EU.

Notice: Observe the national local regulations in the location where the device is to be used.

Trademark Attribution

Qualcomm is a trademark of Qualcomm Incorporated, registered in the United States and other countries, used with permission. aptX is a trademark of Qualcomm Technologies international, Ltd., registered in the United States and other countries, used with permission.

Specification

Connection type	Bluetooth 2.4Ghz
Bluetooth type	V4.1
Bluetooth profile	HSP 1.2, HFP 1.6, A2DP 1.2, AVRCP 1.4 , aptX low latency, AAC
Codec	SBC, aptX low latency, AAC
Driver Type	Dynamic
Driver size	5.8mm, inner-metal coated diaphragm
Impedance	32 Ohm
Battery life (estimated)	Up to 4 hours
Battery type	Lithium-ion battery, Typical 3.7V/(Left) 80mAh, (Right) 50mAh, (Charging case) 500mAh
Microphone sensitivity	-42 +/-3 dB
Frequency response	20Hz - 20kHz
Sensitivity	92dB +/-3dB at 1KHz
Range	Up to 10m (33ft)
Weight	A pair of earphones (incl.CP350 tips) 11g, Charging case 44g



nuforce.optoma.com